

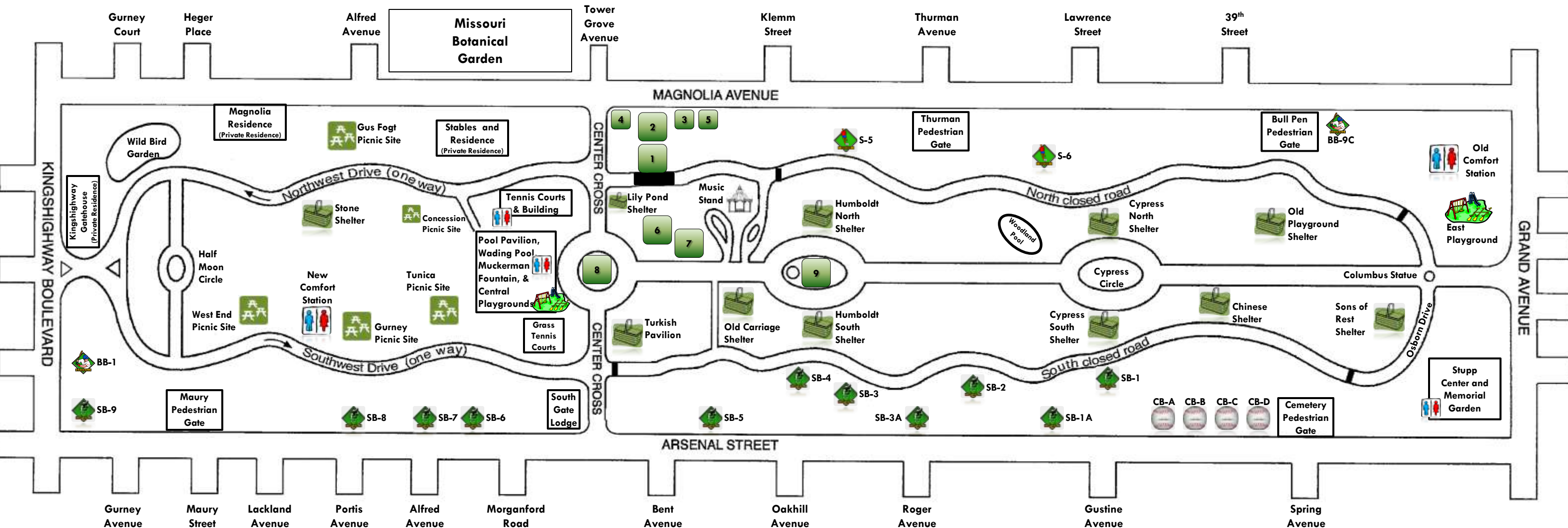

# Tower Grove Park Map

4256 Magnolia Avenue  
St. Louis, Missouri 63110  
314-771-2679



Tower Grove Park is open daily from sunrise to 10 p.m.

Tower Grove Park is a public park owned by the City of St. Louis, and governed by a Board of Commissioners appointed under the authority of the Missouri Supreme Court.

Tower Grove Park is a National Historic Landmark founded and donated by Henry Shaw.

Visit us at [www.towergrovepark.org](http://www.towergrovepark.org)

### Legend:

- 1 – Piper Palm House
- 2 – Piper Plant House (**Park Office**)
- 3 – Park Greenhouse
- 4 – Director’s Residence
- 5 – Park Maintenance Complex
- 6 – Lily Ponds
- 7 – Ruins and Fountain Pond
- 8 – Shakespeare Statue and Flag Circle
- 9 – Humboldt Statue and Humboldt Circle

### Ball fields Legend:

- BB = Baseball**
- S = Soccer**
- SB = Softball**
- CB = Corkball**